



Office of the President

BOARD OF TRUSTEES

November 14, 2024

RESOLUTION NO. 2024.74 – MAKING A SEQRA DETERMINATION FOR THE CONSTRUCTION OF THE AUTOMOTIVE TECHNOLOGY CENTER ON THE MICHAEL J. GRANT CAMPUS (CP 2203)

WHEREAS, in accordance with the Memorandum of Understanding between the County of Suffolk and Suffolk County Community College, dated April 16, 2009, the College Board of Trustees serves as Lead Agency for determinations issued pursuant to the State Environmental Quality Review Act ("SEQRA") (NYS Environmental Conservation Law, Article 8) and its implementing regulations at Title 6 NYCRR Part 617, and

WHEREAS, under Capital Project 2203, the College will be constructing an Automotive Technology Center on the Michael J. Grant Campus, funded in both the current Adopted County Capital Program and the current Adopted New York State Budget, and

WHEREAS, in accordance with 6 NYCRR § 617.6(a)(3), a Short Environmental Assessment Form (SEAF) was prepared by the College, as shown in *Attachment 1*, attached hereto, to systematically consider environmental factors involved with this action to make a reasoned determination regarding the likelihood that the action may have a significant adverse impact to the environment, and

WHEREAS, this review has indicated that the construction of the Automotive Technology Center on the Michael J. Grant Campus will not have a significant adverse effect on the environment, and

WHEREAS, accordingly, the College recommends that this project be considered an "Unlisted Action," pursuant to 6 NYCRR § 617.2(a), be it therefore

RESOLVED, that the Board of Trustees hereby finds and determines that the Automotive Technology Center to be constructed at the Michael J. Grant Campus constitutes an "Unlisted Action," pursuant to 6 NYCRR § 617.2(a), and be it further

RESOLVED, that pursuant to 6 NYCRR § 617.7(b), after due deliberation, review, and analysis of the information contained in the SEAF and other relevant information, the Board of Trustees hereby determines that the construction of the Automotive Technology Center will not have a significant adverse environmental impact and issues a negative declaration for the following reasons:

Central Administration
533 College Road
Selden, NY 11784-2899
(631) 451-4112

Ammerman Campus
533 College Road
Selden, NY 11784-2899
(631) 451-4110

Western Campus
Crooked Hill Road
Brentwood, NY 11717-1092
(631) 851-6700

Eastern Campus
121 Speonk-Riverhead Road
Riverhead, NY 11901-3499
(631) 548-2500



RESOLUTION NO. 2024.74 – Continued

1. The action will not exceed any of the criteria contained in 6 NYCRR § 617.7(c), which sets forth thresholds for determining significant adverse impacts on the environment;
2. The action does not adversely impact air quality, surface or groundwater, traffic or noise levels, nor substantially increase solid waste production, erosion, flooding, leaching or drainage problems as the topography remains flat, the building will be sewerred, and storm water will be managed on-site;
3. The removal of vegetation associated with the action will not impact occupied endangered species habitat through the practice of avoidance in accordance with New York State Department of Environmental Conservation guidance and recommendations, as no trees will be removed between March 1st and November 30th of any calendar year;
4. As the action does not adversely impact groundwater, the action does not impair the environmental characteristics of the state listed Critical Environmental Area (CEA) identified as Oaks Brush Plains;
5. The action does not conflict with the College's Master Plan;
6. The action does not impair the character or quality of important archeological, historical, architectural or aesthetic resources as the site does not contain a structure that is listed on either the State or National Register of Historic Places;
7. While the site is located in an archeological sensitive area, there is no record of any significant archeological findings within the Campus property and therefore the action does not impair the character or quality of important archeological resources;
8. The increased use of electricity and natural gas associated with the action is not significant relative to the rest of the Michael J. Grant Campus and energy efficient HVAC and lighting technologies will be employed;
9. The action does not create a hazard to human health;
10. The action is consistent with the current use of the land as a community college;
11. The action does not attract a large number of people to the Campus compared to the number of people who would come to the Campus absent the action;
12. The action does not create a material demand for other actions that would meet one or more of the criteria in 6 NYCRR § 617.7(c);

Central Administration
533 College Road
Selden, NY 11784-2899
(631) 451-4112

Ammerman Campus
533 College Road
Selden, NY 11784-2899
(631) 451-4110

Western Campus
Crooked Hill Road
Brentwood, NY 11717-1092
(631) 851-6700

Eastern Campus
121 Speonk-Riverhead Road
Riverhead, NY 11901-3499
(631) 548-2500

RESOLUTION NO. 2024.74 – Continued

13. The action does not result in changes to two or more elements of the environment that when considered together result in a substantial adverse impact on the environment;
14. There are no related actions to this action that when considered cumulatively would meet one or more of the criteria in 6 NYCRR § 617.7(c);
15. All necessary State and County approvals will be obtained.

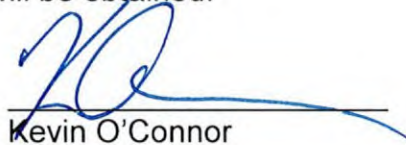

Kevin O'Connor
Secretary

Short Environmental Assessment Form
Part 1 - Project Information

Instructions for Completing

Part 1 – Project Information. The applicant or project sponsor is responsible for the completion of Part 1. Responses become part of the application for approval or funding, are subject to public review, and may be subject to further verification. Complete Part 1 based on information currently available. If additional research or investigation would be needed to fully respond to any item, please answer as thoroughly as possible based on current information.

Complete all items in Part 1. You may also provide any additional information which you believe will be needed by or useful to the lead agency; attach additional pages as necessary to supplement any item.

Part 1 – Project and Sponsor Information			
Name of Action or Project: Automotive Technology Center			
Project Location (describe, and attach a location map): Crooked Hill Road, Brentwood, NY 11717-1092			
Brief Description of Proposed Action: The new Automotive Technology Center will be a hub for advanced automotive and transportation training for the Long Island and greater New York region. This Center will provide educational experiences to prepare and train new and incumbent workers for careers in this area of high-need. The Center will be a national model for automotive and alternative fuels training featuring public / private partnership with the goal of providing a highly-skilled workforce for the local transportation sector. The location on the Grant Campus will allow for a centralized regional presence and will leverage and collaborate with existing and future workforce and STEM resources on the campus. Site development includes the potential for a 70,000 square foot single story building, associated parking facilities and pedestrian pathways.			
Name of Applicant or Sponsor: Suffolk County Community College		Telephone: 631-451-4233	
		E-Mail: demaloj@sunysuffolk.edu	
Address: 533 College Road			
City/PO: Selden		State: NY	Zip Code: 11784
1. Does the proposed action only involve the legislative adoption of a plan, local law, ordinance, administrative rule, or regulation? If Yes, attach a narrative description of the intent of the proposed action and the environmental resources that may be affected in the municipality and proceed to Part 2. If no, continue to question 2.		NO <input checked="" type="checkbox"/>	YES <input type="checkbox"/>
2. Does the proposed action require a permit, approval or funding from any other government Agency? If Yes, list agency(s) name and permit or approval: Funding approvals from the State University of New York and Suffolk County. Building permit issued by Suffolk County Community College		NO <input type="checkbox"/>	YES <input checked="" type="checkbox"/>
3. a. Total acreage of the site of the proposed action? _____ 5.626 acres			
b. Total acreage to be physically disturbed? _____ 5.626 acres			
c. Total acreage (project site and any contiguous properties) owned or controlled by the applicant or project sponsor? _____ 207 acres			
4. Check all land uses that occur on, are adjoining or near the proposed action: <input type="checkbox"/> Urban <input type="checkbox"/> Rural (non-agriculture) <input type="checkbox"/> Industrial <input type="checkbox"/> Commercial <input checked="" type="checkbox"/> Residential (suburban) <input type="checkbox"/> Forest <input type="checkbox"/> Agriculture <input type="checkbox"/> Aquatic <input checked="" type="checkbox"/> Other(Specify): Educational <input type="checkbox"/> Parkland			

5. Is the proposed action, a. A permitted use under the zoning regulations? b. Consistent with the adopted comprehensive plan?	NO	YES	N/A
	<input type="checkbox"/>	<input checked="" type="checkbox"/>	<input type="checkbox"/>
	<input type="checkbox"/>	<input checked="" type="checkbox"/>	<input type="checkbox"/>
6. Is the proposed action consistent with the predominant character of the existing built or natural landscape?	NO	YES	
	<input type="checkbox"/>	<input checked="" type="checkbox"/>	
7. Is the site of the proposed action located in, or does it adjoin, a state listed Critical Environmental Area? Special Groundwater Protection Area - Oaks Brush Plains Map #4 If Yes, identify: _____	NO	YES	
	<input type="checkbox"/>	<input checked="" type="checkbox"/>	
8. a. Will the proposed action result in a substantial increase in traffic above present levels? b. Are public transportation services available at or near the site of the proposed action? c. Are any pedestrian accommodations or bicycle routes available on or near the site of the proposed action?	NO	YES	
	<input checked="" type="checkbox"/>	<input type="checkbox"/>	
	<input type="checkbox"/>	<input checked="" type="checkbox"/>	
	<input type="checkbox"/>	<input checked="" type="checkbox"/>	
9. Does the proposed action meet or exceed the state energy code requirements? If the proposed action will exceed requirements, describe design features and technologies: _____ _____	NO	YES	
	<input type="checkbox"/>	<input checked="" type="checkbox"/>	
10. Will the proposed action connect to an existing public/private water supply? If No, describe method for providing potable water: _____ _____	NO	YES	
	<input type="checkbox"/>	<input checked="" type="checkbox"/>	
11. Will the proposed action connect to existing wastewater utilities? If No, describe method for providing wastewater treatment: _____ _____	NO	YES	
	<input type="checkbox"/>	<input checked="" type="checkbox"/>	
12. a. Does the project site contain, or is it substantially contiguous to, a building, archaeological site, or district which is listed on the National or State Register of Historic Places, or that has been determined by the Commissioner of the NYS Office of Parks, Recreation and Historic Preservation to be eligible for listing on the State Register of Historic Places? b. Is the project site, or any portion of it, located in or adjacent to an area designated as sensitive for archaeological sites on the NY State Historic Preservation Office (SHPO) archaeological site inventory?	NO	YES	
	<input checked="" type="checkbox"/>	<input type="checkbox"/>	
	<input type="checkbox"/>	<input checked="" type="checkbox"/>	
13. a. Does any portion of the site of the proposed action, or lands adjoining the proposed action, contain wetlands or other waterbodies regulated by a federal, state or local agency? b. Would the proposed action physically alter, or encroach into, any existing wetland or waterbody? If Yes, identify the wetland or waterbody and extent of alterations in square feet or acres: _____ _____ _____	NO	YES	
	<input checked="" type="checkbox"/>	<input type="checkbox"/>	
	<input checked="" type="checkbox"/>	<input type="checkbox"/>	

14. Identify the typical habitat types that occur on, or are likely to be found on the project site. Check all that apply: <input type="checkbox"/> Shoreline <input type="checkbox"/> Forest <input type="checkbox"/> Agricultural/grasslands <input checked="" type="checkbox"/> Early mid-successional <input type="checkbox"/> Wetland <input type="checkbox"/> Urban <input checked="" type="checkbox"/> Suburban		
15. Does the site of the proposed action contain any species of animal, or associated habitats, listed by the State or Federal government as threatened or endangered?	NO <input type="checkbox"/>	YES <input checked="" type="checkbox"/>
16. Is the project site located in the 100-year flood plan?	NO <input checked="" type="checkbox"/>	YES <input type="checkbox"/>
17. Will the proposed action create storm water discharge, either from point or non-point sources? If Yes,	NO <input type="checkbox"/>	YES <input checked="" type="checkbox"/>
a. Will storm water discharges flow to adjacent properties?	<input checked="" type="checkbox"/>	<input type="checkbox"/>
b. Will storm water discharges be directed to established conveyance systems (runoff and storm drains)?	<input type="checkbox"/>	<input checked="" type="checkbox"/>
If Yes, briefly describe: _____		
A combination of dry wells and existing storm water sewers. _____		
18. Does the proposed action include construction or other activities that would result in the impoundment of water or other liquids (e.g., retention pond, waste lagoon, dam)? If Yes, explain the purpose and size of the impoundment: _____	NO <input checked="" type="checkbox"/>	YES <input type="checkbox"/>
19. Has the site of the proposed action or an adjoining property been the location of an active or closed solid waste management facility? If Yes, describe: _____	NO <input checked="" type="checkbox"/>	YES <input type="checkbox"/>
20. Has the site of the proposed action or an adjoining property been the subject of remediation (ongoing or completed) for hazardous waste? If Yes, describe: _____	NO <input type="checkbox"/>	YES <input checked="" type="checkbox"/>
Heartland Industrial Park groundwater contamination investigation. Classification N - No Further Action at this Time		
I CERTIFY THAT THE INFORMATION PROVIDED ABOVE IS TRUE AND ACCURATE TO THE BEST OF MY KNOWLEDGE		
Applicant/sponsor/name: <u>Jon DeMaio</u> Date: <u>11-4-24</u>		
Signature:  Title: <u>Interim AVP Capital & Facilities Management</u>		

Project: Capital Project 2203 - Automotive

Date:

**Short Environmental Assessment Form
Part 2 - Impact Assessment**

Part 2 is to be completed by the Lead Agency.

Answer all of the following questions in Part 2 using the information contained in Part 1 and other materials submitted by the project sponsor or otherwise available to the reviewer. When answering the questions the reviewer should be guided by the concept "Have my responses been reasonable considering the scale and context of the proposed action?"

	No, or small impact may occur	Moderate to large impact may occur
1. Will the proposed action create a material conflict with an adopted land use plan or zoning regulations?	<input checked="" type="checkbox"/>	<input type="checkbox"/>
2. Will the proposed action result in a change in the use or intensity of use of land?	<input checked="" type="checkbox"/>	<input type="checkbox"/>
3. Will the proposed action impair the character or quality of the existing community?	<input checked="" type="checkbox"/>	<input type="checkbox"/>
4. Will the proposed action have an impact on the environmental characteristics that caused the establishment of a Critical Environmental Area (CEA)?	<input checked="" type="checkbox"/>	<input type="checkbox"/>
5. Will the proposed action result in an adverse change in the existing level of traffic or affect existing infrastructure for mass transit, biking or walkway?	<input checked="" type="checkbox"/>	<input type="checkbox"/>
6. Will the proposed action cause an increase in the use of energy and it fails to incorporate reasonably available energy conservation or renewable energy opportunities?	<input checked="" type="checkbox"/>	<input type="checkbox"/>
7. Will the proposed action impact existing:		
a. public / private water supplies?	<input checked="" type="checkbox"/>	<input type="checkbox"/>
b. public / private wastewater treatment utilities?	<input checked="" type="checkbox"/>	<input type="checkbox"/>
8. Will the proposed action impair the character or quality of important historic, archaeological, architectural or aesthetic resources?	<input checked="" type="checkbox"/>	<input type="checkbox"/>
9. Will the proposed action result in an adverse change to natural resources (e.g., wetlands, waterbodies, groundwater, air quality, flora and fauna)?	<input checked="" type="checkbox"/>	<input type="checkbox"/>
10. Will the proposed action result in an increase in the potential for erosion, flooding or drainage problems?	<input checked="" type="checkbox"/>	<input type="checkbox"/>
11. Will the proposed action create a hazard to environmental resources or human health?	<input checked="" type="checkbox"/>	<input type="checkbox"/>



PRINT FORM

Project:	Capital Project 2203
Date:	

**Short Environmental Assessment Form
Part 3 Determination of Significance**

For every question in Part 2 that was answered "moderate to large impact may occur", or if there is a need to explain why a particular element of the proposed action may or will not result in a significant adverse environmental impact, please complete Part 3. Part 3 should, in sufficient detail, identify the impact, including any measures or design elements that have been included by the project sponsor to avoid or reduce impacts. Part 3 should also explain how the lead agency determined that the impact may or will not be significant. Each potential impact should be assessed considering its setting, probability of occurring, duration, irreversibility, geographic scope and magnitude. Also consider the potential for short-term, long-term and cumulative impacts.

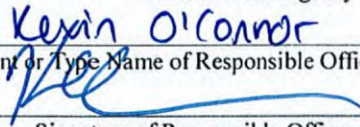
This action will not have a significant adverse environmental impact as described in Suffolk County Community College Board of Trustees Resolution 2024.74.

<input type="checkbox"/>	Check this box if you have determined, based on the information and analysis above, and any supporting documentation, that the proposed action may result in one or more potentially large or significant adverse impacts and an environmental impact statement is required.
<input checked="" type="checkbox"/>	Check this box if you have determined, based on the information and analysis above, and any supporting documentation, that the proposed action will not result in any significant adverse environmental impacts.
Suffolk County Community College Board of Trustees	November 14, 2024
Name of Lead Agency	Date
Kevin O'Connor	Secretary to Board of Trustees
Print or Type Name of Responsible Officer in Lead Agency	Title of Responsible Officer
	
Signature of Responsible Officer in Lead Agency	Signature of Preparer (if different from Responsible Officer)

PRINT FORM

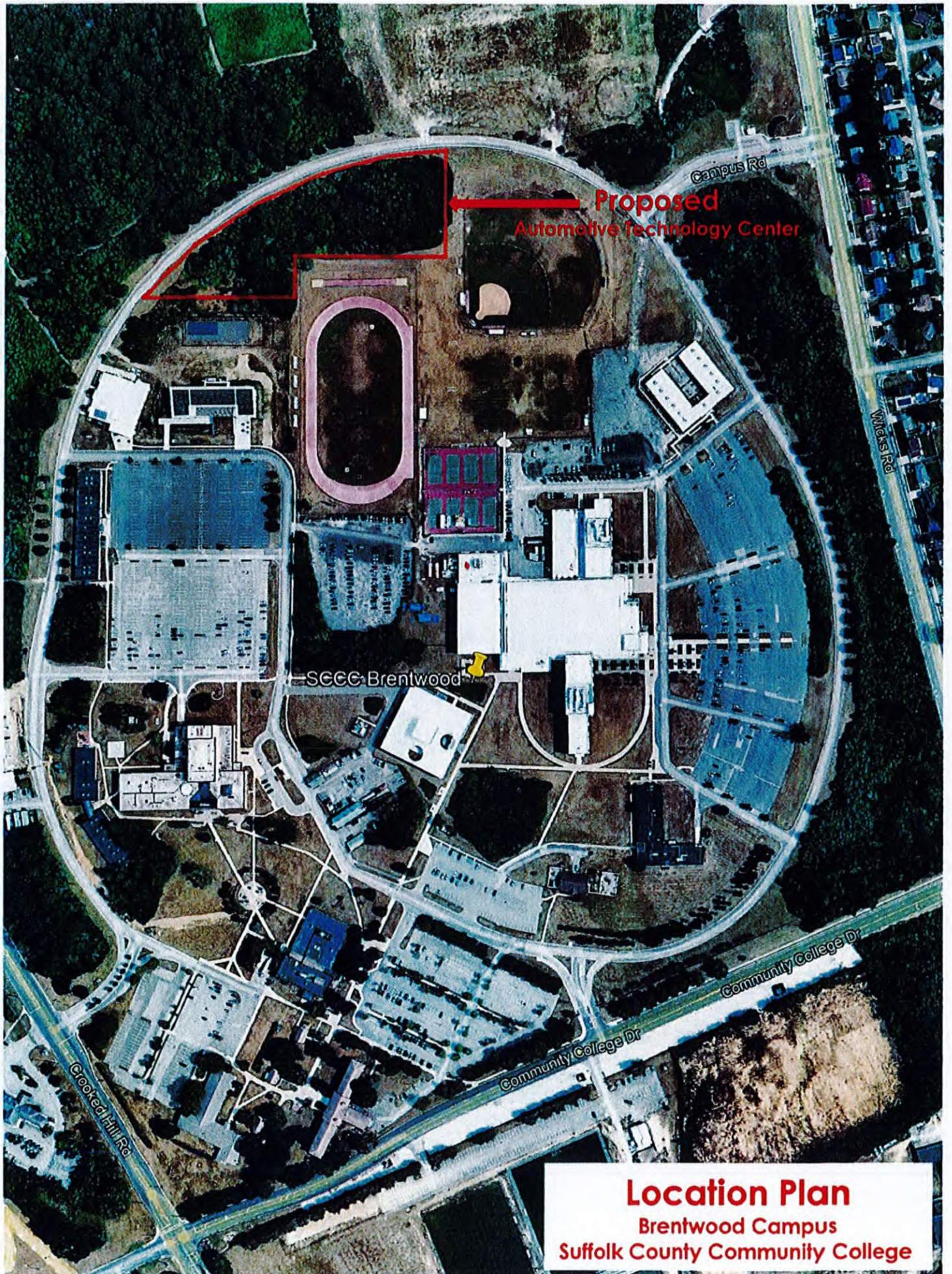

Location Plan
Brentwood Campus
Suffolk County Community College

DESCRIPTION	SYMBOL	
	EXISTING	PROPOSED
BUILDING	[Hatched Box]	[Dashed Box]
FUTURE BUILDING CORN (ALL TYPES)	[Dashed Line]	[Dashed Line]
PAVEMENT EDGE	[Solid Line]	[Solid Line]
CHAIN LINK FENCE	[Dashed Line]	[Dashed Line]
VEGETATION LINE	[Dashed Line]	[Dashed Line]
ELECTRIC SERVICE	[Line with Arrow]	[Line with Arrow]
NATURAL GAS 8"	[Line with Arrow]	[Line with Arrow]
SANITARY SEWER 12"	[Line with Arrow]	[Line with Arrow]
WATER MAIN	[Line with Arrow]	[Line with Arrow]
SANITARY SEWER MANHOLE	[Circle with 'S']	[Circle with 'S']
FIRE HYDRANT	[Circle with 'F']	[Circle with 'F']
WALKWAYS	[Dashed Line]	[Dashed Line]
PARKING ROW C 1'	[Circle with 'P']	[Circle with 'P']
ENTRANCE DOOR	[Circle with 'D']	[Circle with 'D']

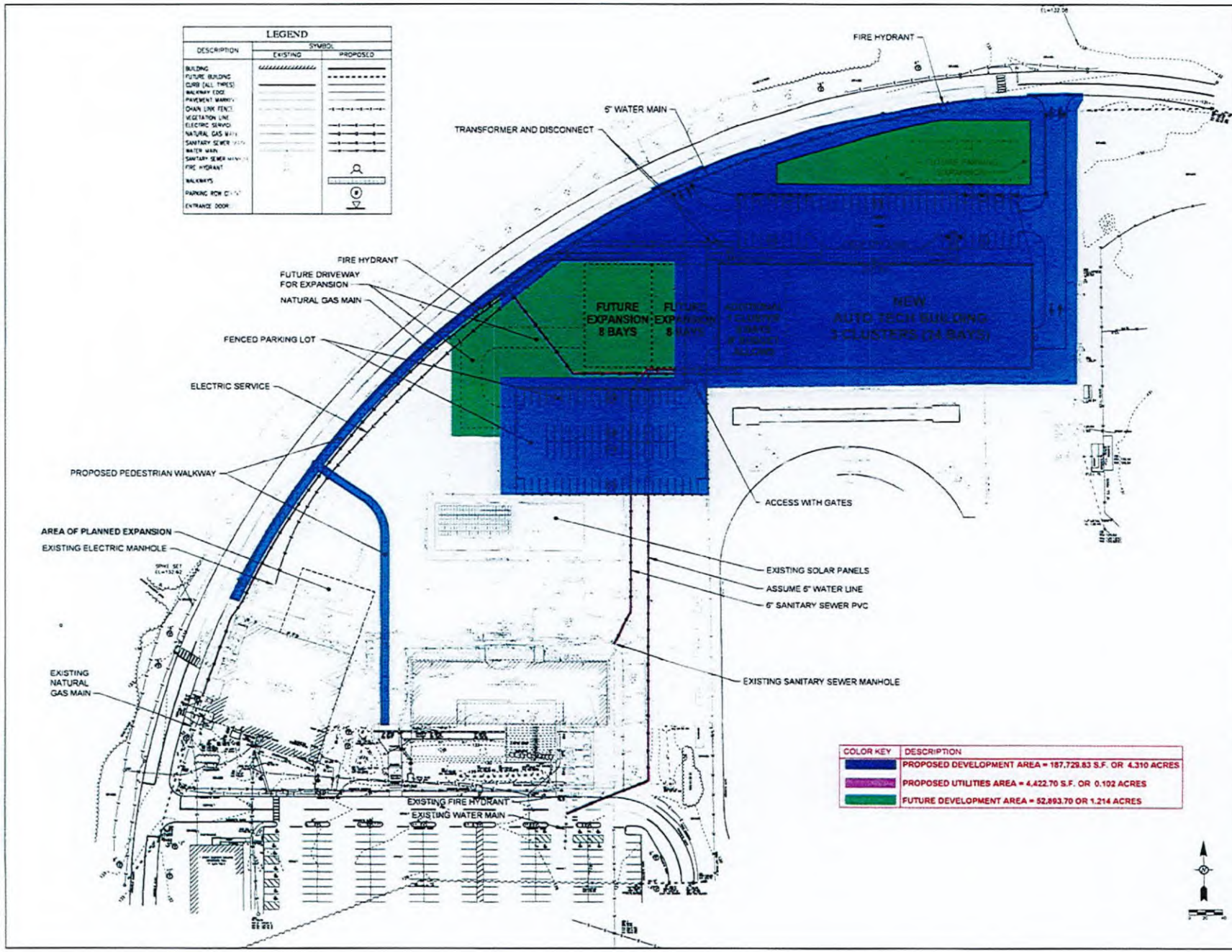

DCAK MSA
ARCHITECTURE AND ENGINEERING

43 HOLENORTH AVENUE
STACON, NEW YORK, NY 10981
www.dcaakmsa.com
Phone: 845.338.1100 Fax: 845.338.1101

Client: Suffolk County Community College
New Automotive Technology Center at the Grant Campus

Project Address:
Cromwell Road
Northwest, NY 11771

Contract No.:
17-0001

Scale:
As Shown

Date:
10/20/17

Sheet No.:
C-200

COLOR KEY	DESCRIPTION
[Blue Box]	PROPOSED DEVELOPMENT AREA = 187,729.83 S.F. OR 4.310 ACRES
[Purple Box]	PROPOSED UTILITIES AREA = 4,422.70 S.F. OR 0.102 ACRES
[Green Box]	FUTURE DEVELOPMENT AREA = 52,893.70 OR 1.214 ACRES

REVISIONS				
No.	Date	Description	By	App.

OVERALL SITE PLAN

C-200

7

Special Groundwater Protection Area (Oak Brush Plains) Critical Environmental Area (CEA) Map #4

Effective Date of Designation: 2-10-88

Designating Agency: Suffolk County

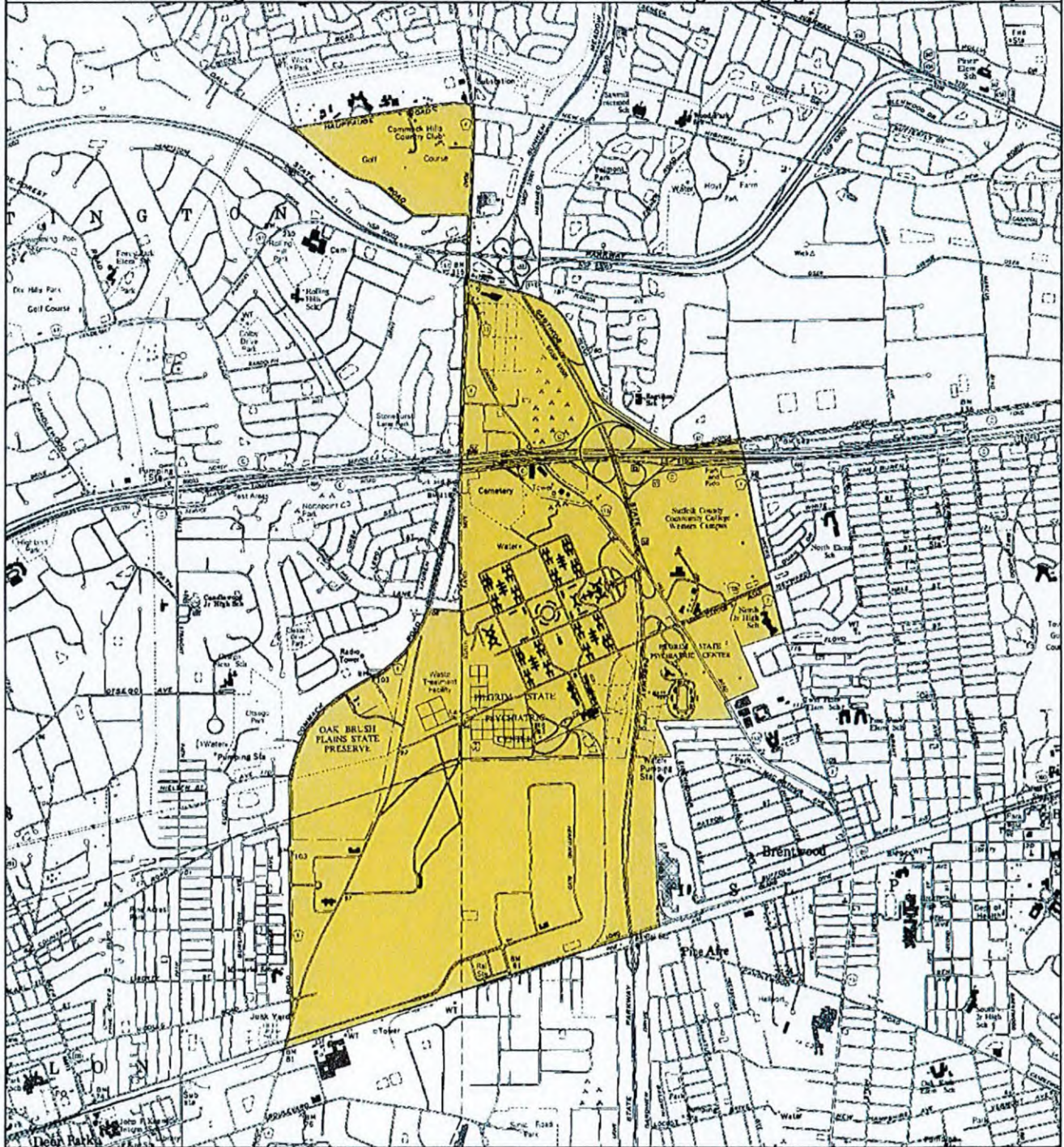

Legend

Special Groundwater Protection Area CEA Map #4

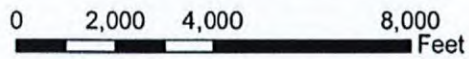

Base Map: 1: 24,000 DOT Planimetric Image

1 inch equals 3,500 feet

Disclaimer: This map was prepared by the New York State Department of Environmental Conservation using the most current data available. It is deemed accurate but is not guaranteed. NYS DEC is not responsible for any inaccuracies in the data. Please contact the designating authority for additional information regarding legal boundary descriptions. SGPA Maps 1 through 9 represent a portion of the SGPA designated as a Critical Environmental Area.

SHPO CRIS Archaeological Site Search, Oct. 22, 2024

USNTypeNameStatus

10305.000005ArchaeologyTIMBER POINT SITE 13-8Undetermined
10305.000007ArchaeologyOLD MILL POND SITEUndetermined
10305.000008ArchaeologyTIMBER POINT SITE 13-7Undetermined
10305.000009ArchaeologyRIVER BEND SITE (UNEVALUATED)Listed
10305.000011ArchaeologyGARDINER COUNTY PARK SITE 19-2Undetermined
10305.000013ArchaeologyGARDINER COUNTY PARK SITE 19-8Undetermined
10305.000014ArchaeologyGARDINER COUNTY PARK SITE 19-1Undetermined
10305.000015ArchaeologyFire Island LighthouseUndetermined
10305.000018ArchaeologyLIGHTHOUSE TRACT: HISTORIC STRATIFIED DEPOSITUndetermined
10305.000130ArchaeologyOAK NECK INDIAN SITE/SECATOGUE NECK INDIAN SITEUndetermined
10305.000269ArchaeologyKOLCZYNSKI PROPERTY SITEUndetermined
10305.000274ArchaeologyHEDGER SITEUndetermined
10305.000275ArchaeologySOUNDING 23 SITEUndetermined
10305.000277ArchaeologyWHEELER HOUSE SITEUndetermined
10305.000279ArchaeologyMORAINES (NCM 192)Undetermined
10305.000280ArchaeologyWILLETTS CREEK (NCM 168)Undetermined
10305.000281ArchaeologyWEST BAY SHORE SITEUndetermined
10305.000282ArchaeologyCEDAR POINT SITEUndetermined
10305.000283ArchaeologyCHAMPLIN CREEK II SITEUndetermined
10305.000286ArchaeologyCOLLINS HOUSE SITE (NCM #188) (UNEVALUATED)Listed
10305.000287ArchaeologyConnetquot 1 SiteListed
10305.000288ArchaeologyConnetquot 2 SiteListed
10305.000289ArchaeologyConnetquot 3 SiteListed
10305.000290ArchaeologyConnetquot 4 SiteListed
10305.000291ArchaeologyCONNETQUOT V SITE (UNEVALUATED)Listed
10305.000292ArchaeologyConnetquot 6 SiteListed
10305.000293ArchaeologyConnetquot 7 SiteListed
10305.000294ArchaeologyConnetquot 8 SiteListed
10305.000295ArchaeologyConnetquot 9 SiteListed
10305.000296ArchaeologyConnetquot 10 SiteListed
10305.000349ArchaeologyFOUNDATION OF THE LUDLOW HOUSEUndetermined
10305.000350ArchaeologyPEPPERIDGE HALL SITEUndetermined
10305.000486ArchaeologyBAYPORT BARREL FACTORY SITEUndetermined
10305.000599ArchaeologyROOSEVELT ESTATE OUTBUILDING SITESListed
10305.000603ArchaeologyFRANKLIN AVE SITE (FOUNDATION)Undetermined
10305.000604ArchaeologyJOHNSON AVE SITE (FOUNDATION)Undetermined
10305.000605ArchaeologyCamp CheerfulUndetermined
10305.000607ArchaeologyFRANK PENNEY BOAT SHOP (SUFFOLK MARINE MUSEUM)Eligible
10305.000608ArchaeologySANS SOUCI LAKES - CRANBERRY BOGSUndetermined
10305.000610ArchaeologyLOPPED TREES - ROW MARKING OLD GILLETTE FARM BOUNDARYUndetermined
10305.000748ArchaeologySELBY BURYING GROUNDUndetermined
10305.000749ArchaeologyMUNCY CEMETERY/WEST ISLIP CEMETERYUndetermined
10305.000772ArchaeologyWHEELER CEMETERY (AND POND)Undetermined
10305.000804ArchaeologyUNION CEMETERY & JAN HUS STATUEUndetermined

10305.000864 Archaeology VAN WYEN HOUSE Undetermined
10305.000882 Archaeology BROOKWOOD HALL PREHISTORIC SITE Undetermined
10305.000930 Archaeology RAZED FACTORY SITE Undetermined
10305.000931 Archaeology Greenberg House Undetermined
10305.000941 Archaeology AMERICAN INN (PETIT TRIANON) SITE Undetermined
10305.001105 Archaeology CENTRAL ISLIP STATE HOSPITAL ORIGINAL COMPLEX Undetermined
10305.001156 Archaeology ROMAZ SITE (PREHISTORIC) Undetermined
10305.001218 Archaeology "Pilgrim Site (SUBI-2516 NYSM 11618)" Undetermined
10305.001234 Archaeology The KoC Site (NYSM 11661) Undetermined
10305.001235 Archaeology Terry road Precontact Site Undetermined
10305.001236 Archaeology Pond Road Foundation Historic Site Undetermined
10305.001492 Archaeology Sagtikos Manor Historical Site Undetermined
10305.001580 Archaeology U.S. Naval Radio Compass Station/U.S. Coast Guard Annex Undetermined
10305.001787 Archaeology Isolated Finds Undetermined

SUFFOLK COUNTY, NEW YORK



11